

# Coffee Art C Touch

## Utility Specifications

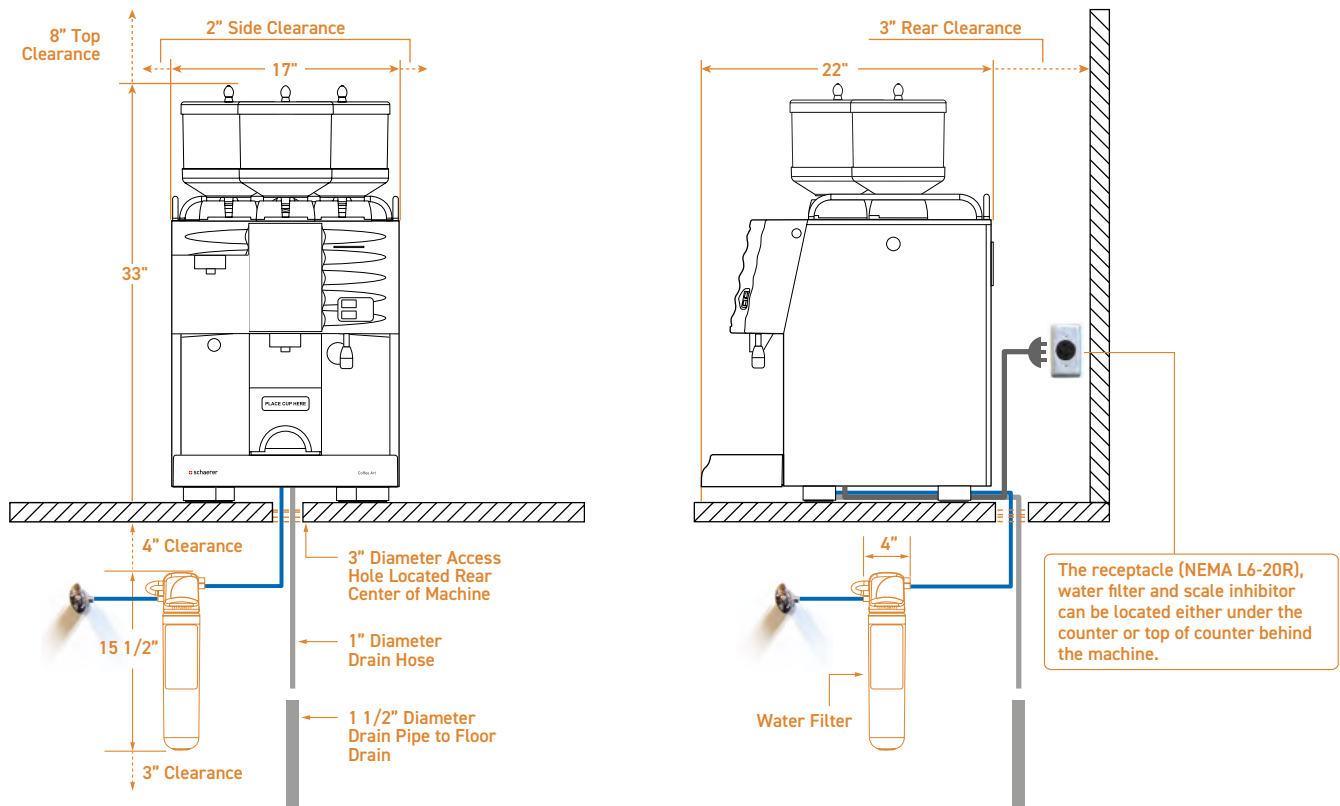

# Coffee Art C Touch

## Power, water supply and access requirements

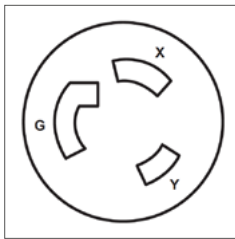

- Receptacle type: NEMA L6-30R
- 3 Prong twist-lock
- Breaker panel: 20 Amp dedicated 220V single phase circuit
- Actual maximum load: 16 Amps



- Access hole with collar (no sharp edges)
- Located centrally under machine for water and drain hose
- Diameter: Minimum 3"



- Water shut-off valve with 3/8" compression fitting
- Back flow preventer in accordance with local requirements



- Drain pipe to floor drain
- Copper or PVC in accordance with local health codes and regulations
- Diameter: 1.5" or larger



The receptacle, water shut-off valve and drain pipe must be within 3 feet (36") of the center of the location (footprint) of the machine.

Ideal under counter space for softener: 30" (minimum requirement: 26").

**i** **Notes:** Access hole is only required if any of the utility hook-ups are located under the counter.