

Coffee Art Plus (Touch)

Daily Cleaning Instructions

- ⓘ Read and follow the instructions carefully before you begin the daily cleaning procedure. This procedure should be performed on a daily basis or when prompted by the machine display. Never reach into the machine or under the coffee spout during the automatic cleaning cycle!
- ⓘ When the "Start cleaning" message appears on the screen, follow the machine prompts to initial the clean cycle. **Note:** In some configurations, the machine will automatically initiate the cleaning cycle after two hours of the "Start cleaning" message appears. During that time all product buttons will be locked until the procedure is completed.
- ⓘ To order cleaning supplies please call 888.989.3004.



1. Use only Schaerer cleaning supplies for this procedure.



2. Fill large steaming pitcher with 16oz of water and mix in (1oz/30ml) Schaerer Steam Wand Cleaner.



3. Submerge steam wand into steaming pitcher and press the LATTE STEAM icon to heat solution. After steam wand shuts off automatically then let it soak for 5 minutes.

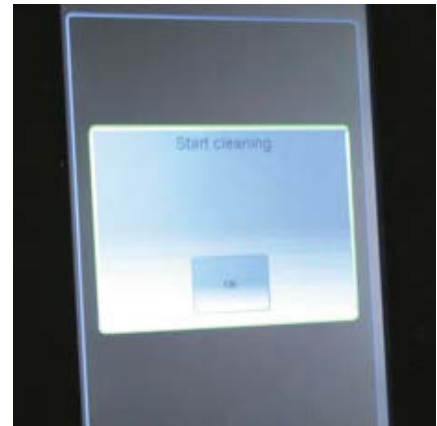

4. When the "Start cleaning" message appears on the screen, press "OK" and move to the next step. **Note:** The message may or may not appear, depending on programming.

Coffee Art Plus (Touch)

Daily Cleaning Instructions



5. Press the  icon to go into the service menu. In some configurations, this icon may be hidden. If hidden, press and hold the same area (bottom left corner) for 3-5 seconds. Service menu will appear.

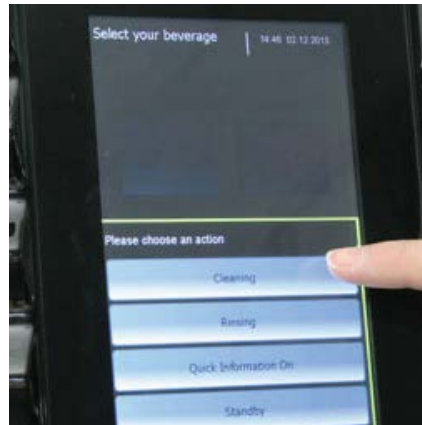

6. Select "Cleaning"



7. Immediately remove grounds bin within 6 seconds. Empty coffee grounds into trash can. Wash, rinse, sanitize bin and set aside.



8. Remove metal shield above grounds bin and set aside.

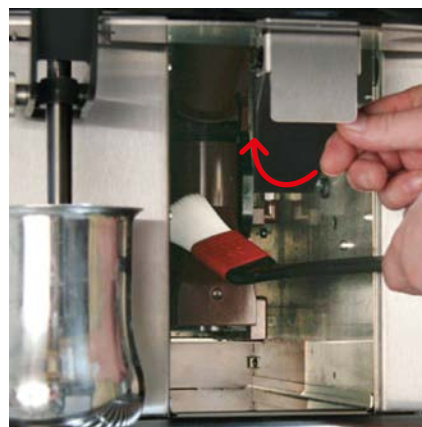

9. Use large cleaning brush to wipe coffee grounds from brew unit and surrounding areas into drip tray.



10. Put back metal shield and slide coffee grounds bin back into place.

Coffee Art Plus (Touch)

Daily Cleaning Instructions



11. Lift dome lid and drop in one Schaerer cleaning tablet. Close lid after dropping tablet. Press "OK" on the screen.



12. Press "Continue" on the screen to activate cleaning cycle. **Cleaning runs (4:33 min.)**

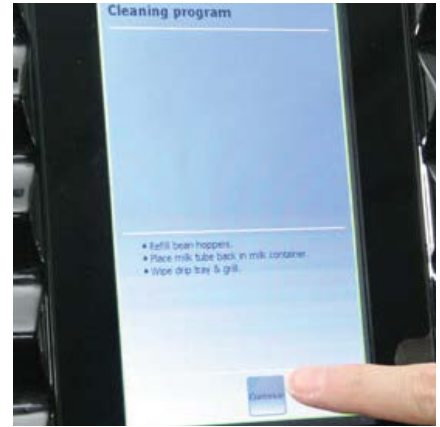

13. Refill beans if necessary. Press "Continue" to return to normal operating mode.



14. When automated cleaning cycle is complete, empty pitcher into drip tray. Wipe steam wand with a thick, clean, damp cloth. **Be careful, wand will be very hot!**



15. Submerge steam wand into cold water once to rinse, then discard water. Wipe steam wand with a clean, damp cloth.



16. After wiping off wand, point it toward drip tray and purge by pressing the  button.